

SPREADER DOWN/UP

Thank you for purchasing the Spreader Down/Up light

The product offers a soft light on the deck or up the mast at a very low power consumption. The product is designed in high quality for many years usage in harsh marine environment.

The installation is easy and the product fits to many different spreader sizes and curvatures.

Connecting power

- Supply voltage between 10VDC and 30VDC
- Recommended <2A (slow) fuse or circuit breaker

Specifications

Housing	UV/corrosions resistant surface treated aluminium
Lens	UV resistant PMMA
Spreader curvature	R50 - R800
Colour temperature	4000 K
Lifetime	> 40.000 hours
Light Source	LED
Voltage protection	Reverse polarity protected Spike protected to +500 volts Electromagnetic Compatibilities (EMC)
Power Consumption	2 W
Dimensions	50mm (diameter) x 20mm (height)
Weight	80g
IP class	IP68
Warranty:	2 years product limited warranty. If you want to claim a warranty for your product, please write an email to claim@norbymarine.com

Step 1 Drill \varnothing 10mm hole in center of spreader light placement

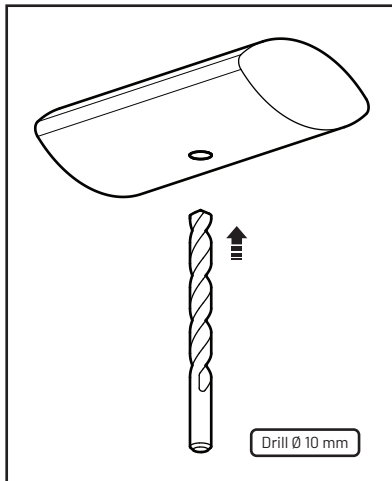

Step 2 Place light on spreader with the cable through the hole

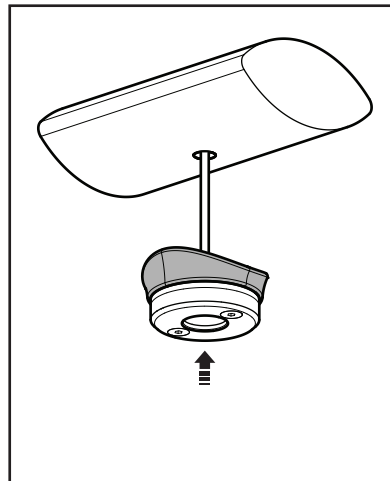

Step 3 Drill \varnothing 4.2mm holes through light mounting holes

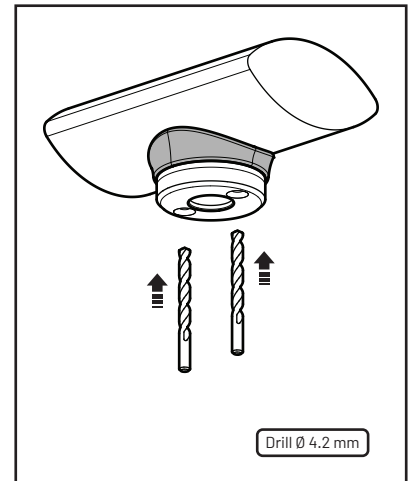

Step 4 Cut M5 threads through light mounting holes

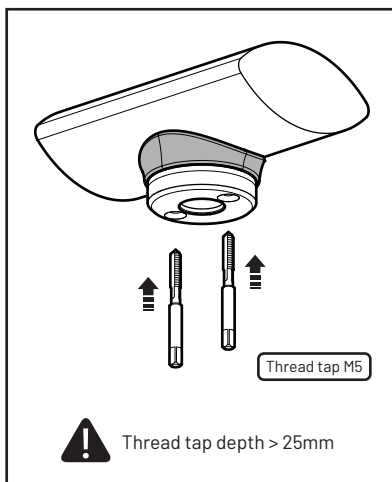

Step 5 Fasten light to spreader with M5 mounting screws

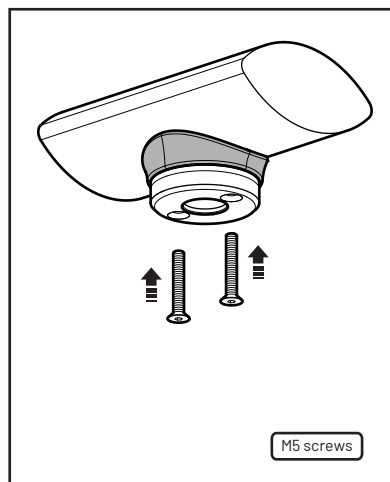

Step 6 Connect cable to vessels electrical circuit. Use supply voltage between 10VDC and 30VDC (Typically 12 or 24 VDC). Avoid chafe mounting the cable. Route away of electric motors or other items with large inductive fields. Route away from heat sources such as motor or heater.

Colour	Connect to
Black	Negative (-)
Red	Positive (+)

Service

- Clean ONLY with freshwater or a damp cloth
- DO NOT use alcohol or thinner for cleaning. This could damage the lens.
- Lubricate the connector pins if needed.